

PT 1000 SENSOR

with integrated converter

Item No.: 423.212



DESCRIPTION OF FUNCTIONS

The sensor measures the ambient temperature with a PT1000 resistance measurement. The temperature between -50 and 70°C is converted into voltage values between 0 V and 10 V.

TECHNICAL DATA

| | |
|-----------------------|--|
| Measuring range : | -50 to 50°C |
| Supply voltage : | DC: 15 to 24 V, or AC: 24 V |
| Power consumption : | DC: max. 12 mA at 24 V output: |
| Output signal : | 0 to 10 V, min. load 5 kΩ |
| Connection terminal : | Screw terminal, max. 1.5 mm ² |
| Protection class: | IP 65 |

ENCLOSURE DIMENSIONS & ASSIGNMENT OF CONNECTIONS

Dimensions in millimeters:

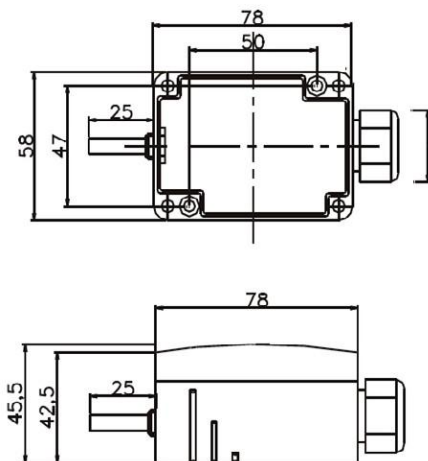

Connection (3-line control):

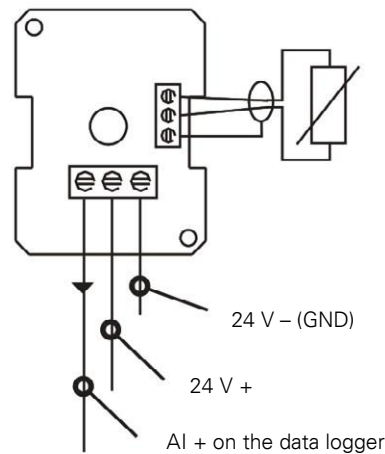

This assignment of connections only applies if the sensor is supplied via the built-in power supply unit of the data logger, as AI- and GND 24 V are bridged internally here.